

#2017158506, #2017158507, #2017158508, #2017158509

## IRISH SETTER CLUB OF GREATER TULSA, INC.

**Specialty Shows, Sweepstakes, & All-Breed Obedience Trials**

**Obedience classes limited each day to 50 with preference given to Irish Setters**

OBEDIENCE OPEN TO ALL AKC RECOGNIZED BREEDS – SPECIALTY & SWEEPSTAKES ARE IRISH SETTERS ONLY



THIS SHOW WILL BE INDOORS AND UNBENCHED

Air Conditioned, Fully Matted Rings

**SATURDAY, SEPTEMBER 23, 2017**

Morning & Afternoon Conformation

All Breed Obedience Obedience (2)

**Companion Dog School of Tulsa**

**4411 South 91<sup>st</sup> East Ave. - Tulsa, OK 74145**

SHOW HOURS: 8:00 a.m. to 6:00 p.m.

See Judging Program for Show Opening

ONLINE ENTRY (Recommended): [enterdogevent.com](http://enterdogevent.com)

CLUB WEBSITE: [iscgt.org](http://iscgt.org)

**ENTRIES CLOSE AT 6:00 p.m. on Wednesday, September 6, 2017**

OBEDIENCE ENTRIES CLOSE AT 6:00 p.m. on Wednesday, September 6, 2017 or when the numerical limits have been reached at the Secretary's address, if reached prior to this date.

MAIL ALL ENTRIES WITH CHECKS PAYBLE TO:

ISCGT

P.O. Box 4567 – Tulsa, OK 74159 – (918) 906-3776

EMAIL: [event@iscgt.org](mailto:event@iscgt.org)



Permission has been granted by the American Kennel Club for the holding of this event under American Kennel Club rules and regulations.

Gina M. Dinardo, Secretary

## OFFICERS

President	Susan Moren
Vice President	Jeanine Harris
Treasurer	Hugh Holly III
Secretary	Anna Vaughn

8316 East 14<sup>th</sup> St. - Tulsa, OK 74112 (918) 906-3776 - [anna@cme-usa.com](mailto:anna@cme-usa.com)

## BOARD OF DIRECTORS

Sarah Schroeder	Jana Davis	Holly Kruse
-----------------	------------	-------------

## SHOW COMMITTEE

Show & Obedience Chairman	Susan Moren
Show Secretary	Jana Davis
Chief Ring Steward	Londa Warren
Trophies	Sarah Schroeder
Grounds	Hugh Holly III

Show Photographer	Sonja Jo Hahn
-------------------	---------------

PO Box 602 - Bixby, OK 74008 [shutterbugrebel@aol.com](mailto:shutterbugrebel@aol.com)

## JUDGES

<b>Saturday Morning, September 23 Event# 2017158506</b> Sweepstakes, Puppy and Veteran	<b>Mary Goeke</b>
---	-------------------

31557 Lookout Rd. Paola, KS 66071

Conformation Regular & Non-Regular Classes	<b>Patricia Darke (39766)</b>
--	-------------------------------

15847 Porchlight Ln., Eden Prairie, MN 55347

<b>Saturday, September 23 Event# 2017158507</b> Obedience Regular Classes	<b>Karen (Kay) Bedeau (21038)</b>
--	-----------------------------------

27150 Memorial Rd., Hot Springs, SD 57747

<b>Saturday Afternoon, September 23 Event# 2017158508</b> Conformation Regular & Non-Regular Classes	<b>Sandra Novocin (7332)</b>
---	------------------------------

14311 Shirley Bohn Rd., Mount Airy, MD 21771

<b>Saturday, September 23 Event# 2017158509</b> Obedience Regular Classes	<b>James Comunale (27181)</b>
--	-------------------------------

741 Jares Ct., Ballwin, MO 63011

## ENTRY FEES

(All Fees include AKC Recording Fee)

Entry Fee (except as noted below)	\$30.00
Regular Puppy Classes (6-9 mos. & 9-12 mos. Only), Bred By Exhibitor, and Veterans	\$25.00
Sweepstakes	\$25.00
Obedience Second Entry (same dog, same trial)	\$25.00

**ENTRY DEADLINE:** Wednesday, September 6, 2017 – 6:00 p.m.

**SHOW SECRETARY:** Jana Davis PO Box 4567 Tulsa, OK 74159 [event@iscgt.org](mailto:event@iscgt.org)

**ONLINE ENTRY:** [enterdodgevent.com](http://enterdodgevent.com)

## SHOW VETERINARIAN

**Animal Emergency Center, Inc.**  
4055 S. 102<sup>nd</sup> East Ave. – Tulsa, OK 74146  
(918) 665-0508  
Open 24/7

Located less than 1.5 miles from the show site.

**Directions:**  
Turn right (North) out of the show site parking.  
Turn right onto E BA Frontage Rd.  
Turn left onto S. Mingo Rd.  
Take the 2<sup>nd</sup> right onto E 41<sup>st</sup> St.  
Take the 2<sup>nd</sup> left onto S 102<sup>nd</sup> St.  
Located directly behind Popeye's Chicken

## SWEEPSTAKES

Dogs shown in Sweepstakes must also be entered in one of the regular classes at the regular entry fee and on the official AKC entry form. Indicate your Sweepstakes Class with the age division in the space provided for "Additional Class".

### **Sweepstakes Classes Dog & Bitches**

Puppy, 6 mos. & Under 9 mos.	Veteran 7-9 yrs.
Puppy, 9 mos. & Under 12 mos.	Veteran 9-11 yrs.
Junior, 12 mos. & Under 15 mos.	Veteran Over 11 yrs.
Junior, 15 mos. & Under 18 mos.	

### **DIVISION OF ENTRY MONEY AS PRIZES**

35% of total entry fees will be retained by the Club for expenses. The remaining 65% of Sweepstakes Entries will be divided as follows:

BEST IN SWEEPSTAKES – 60%

BEST OF OPPOSITE SEX TO BEST IN SWEEPSTAKES – 40%

### **SWEEPSTAKES RIBBONS**

First Prize	Rose Ribbon
Second Prize	Brown Ribbon
Third Prize	Light Green Ribbon
Fourth Prize	Gray Ribbon
Best Puppy in Sweepstakes	Pink & Green Rosette
Best of Opposite Sex in Puppy Sweepstakes	Lavender Rosette
Best in Veteran Sweepstakes	Pink & Green Rosette
Best of Opposite Sex in Veteran Sweepstakes	Lavender Rosette

## **CONFORMATION**

### **Regular Classes Dogs & Bitches**

Puppy 6 mos. & under 9 mos.  
Puppy 9 mos. & under 12 mos.  
Twelve to Eighteen Month  
Amateur Owner Handler  
Bred-by-Exhibitor  
American Bred  
Open  
Best of Breed

### **Non-Regular Classes Dogs & Bitches**

Veteran

### **CONFORMATION RIBBONS**

#### **Regular Classes**

First Prize	Blue Ribbon
Second Prize	Red Ribbon
Third Prize	Yellow Ribbon
Fourth Prize	White Ribbon
Winners	Purple Rosette
Reserve Winners	Purple & White Rosette
Best of Winners	Blue & White Rosette
Best of Opposite Sex	Red & White Rosette
Best of Breed	Purple & Gold Rosette
Select	Light Blue & White Rosette
Award of Merit	Dark Green Rosette
Best Puppy	Green Rosette

#### **Non-Regular Classes**

First Prize	Rose Ribbon
Second Prize	Brown Ribbon
Third Prize	Light Green Ribbon
Fourth Prize	Gray Ribbon

**OBEDIENCE**  
**Regular Classes**

Beginner Novice A	Novice A	Grad Novice	Open A	Utility A
Beginner Novice B	Novice B		Open B	Utility B

**OBEDIENCE RIBBONS**

First Prize	Blue Ribbon
Second Prize	Red Ribbon
Third Prize	Yellow Ribbon
Fourth Prize	White Ribbon
Highest Scoring Irish Setter in the Regular Classes	Blue & Gold Rosette
Highest Scoring Dog in the Regular Classes	Blue & Gold Rosette
Highest Combined Score (Irish Setter) in Open B & Utility	Blue & Green Rosette
Highest Combined Score in Open B & Utility	Blue & Green Rosette
Qualifying Score in the Regular Classes	Dark Green Ribbon

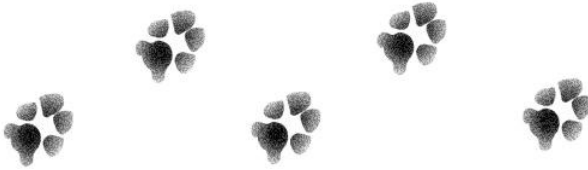

**TROPHIES**

A LIST OF BREED AND OBEDIENCE PRIZES AND TROPHIES OFFERED CAN BE OBTAINED BY WRITING TO THE CLUB SECRETARY: Anna Vaughn - 8316 East 14<sup>th</sup> St., Tulsa, OK 74112

**Trophies will be listed on the Irish Setter Club of Greater Tulsa website:**

**ISCGT.ORG**

**FREE LUNCH PROVIDED!!!**



## ROUTE TO THE SHOW

### From Interstate 44:

Exit #231 S. Memorial Ave.

Drive South to 46<sup>th</sup> Street (light)

Turn Left Drive to South 91<sup>st</sup> East Ave.

Turn Left The show grounds are on the Right.

THERE WILL BE SIGNS POSTED

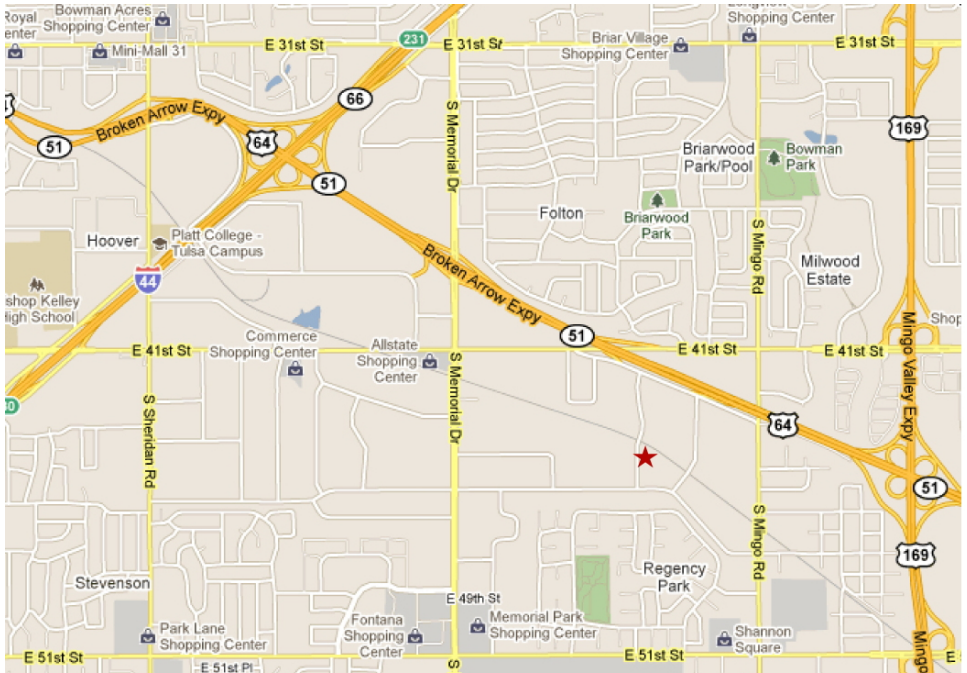

### ACCOMODATIONS

LaQuinta Tulsa East  
6030 East Skelly Dr.  
Tulsa, OK 74135

(918) 665-2630  
(800) 753-3757  
**Pet Friendly**

Expo Square RV Park  
3900 East 15<sup>th</sup> St.  
Tulsa, OK 74114

(918) 744-1113  
exposquare.com

### CONVENIENCES

TGI Fridays  
On the Border  
Promenade Mall

5359 East 41<sup>st</sup> St. Tulsa, OK 74135  
5340 East 41<sup>st</sup> St. Tulsa, OK 74135  
4107 South Yale Ave. Tulsa, OK 74135

## NOTICE TO EXHIBITORS

Entry Fees include \$3.50 AKC Event Fee and \$.50 AKC recording fee.

The building will be made available for setting up crates at 4:00 PM September 22, 2017.

Dogs will be shown indoors in air conditioned building - crating and grooming areas are available.

THERE WILL BE NO ALCOHOL ALLOWED ON THE PREMISIS.

Dogs need be present only for judging. ALL DOGS MUST BE OUT OF THE BUILDING 1 HOUR AFTER JUDGING ENDS. NO EXCEPTIONS!

Entry fees will not be refunded in the event a dog is absent, disqualified, excused by the judge or barred from competition by action of the Show Committee.

If because of riots, civil disturbances or other acts beyond the control of the match-giving club it is impossible to open or complete the match, no refund of entry fees will be made.

Dogs must be ready for judging. The owner or handler of each dog is solely responsible for having such dog ready at ringside when his class is ready to be judged.

Space will not be provided at this show for un-entered dogs.

The show-giving club and its membership assume no responsibility for any loss, damage or injury sustained by exhibitors, handlers or any of their dogs or property, and further assume no responsibility for injury to children.

Officers and members of the Irish Setter of Greater Tulsa will exhibit dogs at this show.

Exhibitors and handlers will be held responsible for clean conditions in and around their crating and grooming area.

Parents will be held responsible for the conduct of their children at this show.

No entry shall be made, and no entry shall be accepted, which specifies any condition as to its acceptance. Entries will not be accepted without fees or signatures.

Changes, additions or corrections to entry forms must be received in writing or by telegram prior to close of entries. Those received by telephone are not acceptable.



## **WE'RE BEGGIN' YOU!**

Our friends at the Companion Dog School of Tulsa have graciously rented their wonderful facility to us so please help us keep their building and grounds clean!

Poop bags are available at the door.

# OFFICIAL AMERICAN KENNEL CLUB ENTRY FORM

## IRISH SETTER CLUB OF GREATER TULSA, INC.

Entries Close Wednesday, September 6, 2017

**OBEDIENCE WILL CLOSE ON THE DATE ABOVE UNLESS THE LIMIT OF 50 HAS BEEN REACHED BEFORE THE CLOSING DATE. IRISH SETTERS HAVE FIRST PREFERENCE IN OBEDIENCE.**

Specialty (Irish Setters Only)

Saturday, September 23, 2017 # 2017158506

Specialty (Irish Setters Only)

Saturday, September 23, 2017 # 2017158508

I ENCLOSE \$ \_\_\_\_\_ for entry fees.

IMPORTANT: Read Carefully the Instructions on the Reverse Side Before Filling Out. Numbers in parenthesis indicate sections of the instructions relevant to the information needed. **PLEASE PRINT**

BREED	VARIETY (1)	SEX
DOG SHOW CLASS (2)(3)	CLASS DIVISION (3) Weight, Color, etc.	
	JR SHOWMANSHIP CLASS	
ADDITIONAL CLASSES	NAME OF JR HANDLER (See Back)	
FULL NAME OF DOG		
<input type="checkbox"/> AKC REG NO. <input type="checkbox"/> AKC LITTER NO. <input type="checkbox"/> ILP NO. <input type="checkbox"/> FOREIGN REG NO. & COUNTRY	Enter Number Here	DATE OF BIRTH
		PLACE OF <input type="checkbox"/> USA <input type="checkbox"/> CANADA <input type="checkbox"/> FOREIGN BIRTH
BREEDER		
SIRE		
DAM		

ACTUAL OWNERS (S) \_\_\_\_\_

(Please Print)

OWNERS ADDRESS \_\_\_\_\_

CITY \_\_\_\_\_ STATE \_\_\_\_\_ ZIP \_\_\_\_\_

NAME OF OWNERS AGENT (if any) AT THE SHOW \_\_\_\_\_

I CERTIFY that I am the actual owner of the dog, or that I am the duly authorized agent of the actual owner whose name I have entered above. In consideration of the acceptance of this entry, I (we) agree to abide by the rules and regulations of The American Kennel Club in effect at the time of this show, obedience trial and/or agility trial, and by any additional rules and regulations appearing in the premium list for this show, obedience trial and/or agility trial, and further agree to be bound by the "Agreement" printed on the reverse side of this entry form. I (we) certify and represent that the dog entered is not a hazard to persons or other dogs. This entry is submitted for acceptance on the foregoing representation and agreement.

SIGNATURE of owner or his agent duly authorized to make this entry \_\_\_\_\_

TELEPHONE NUMBER (Include Area Code) \_\_\_\_\_

E-MAIL ADDRESS \_\_\_\_\_

# OFFICIAL AMERICAN KENNEL CLUB ENTRY FORM

## IRISH SETTER CLUB OF GREATER TULSA, INC.

Entries Close Wednesday, September 6, 2017.

**OBEDIENCE WILL CLOSE ON THE DATE ABOVE UNLESS THE LIMIT OF 50 HAS BEEN REACHED BEFORE THE CLOSING DATE. IRISH SETTERS HAVE FIRST PREFERENCE IN OBEDIENCE.**

Obedience (All Breed)

Saturday, September 23, 2017 # 2017158507

Obedience (All Breed)

Saturday, September 23, 2017 # 2017158509

I ENCLOSE \$ \_\_\_\_\_ for entry fees.

IMPORTANT: Read Carefully the Instructions on the Reverse Side Before Filling Out. Numbers in parenthesis indicate sections of the instructions relevant to the information needed. **PLEASE PRINT**

BREED		VARIETY (1)	SEX
DOG SHOW CLASS (2)(3)		CLASS DIVISION (3) Weight, Color, etc.	
ADDITIONAL CLASSES	OBEDIENCE CLASS (Jump Height)		JR SHOWMANSHIP CLAA
NAME OF (See Back) JR HANDLER (if any)			JR HANLDER NUMBER
FULL NAME OF DOG			
<input type="checkbox"/> AKC REG NO. <input type="checkbox"/> AKC LITTER NO. <input type="checkbox"/> ILP NO. <input type="checkbox"/> FOREIGN REG NO.& COUNTRY		Enter Number Here	DATE OF BIRTH
			PLACE OF BIRTH <input type="checkbox"/> USA <input type="checkbox"/> CANADA <input type="checkbox"/> FOREIGN
BREEDER			
SIRE			
DAM			

ACTUAL OWNERS (S) \_\_\_\_\_

(Please Print)

OWNERS ADDRESS \_\_\_\_\_

CITY \_\_\_\_\_

STATE \_\_\_\_\_

ZIP \_\_\_\_\_

NAME OF OWNERS AGENT (if any) AT THE SHOW \_\_\_\_\_

I CERTIFY that I am the actual owner of the dog, or that I am the duly authorized agent of the actual owner whose name I have entered above. In consideration of the acceptance of this entry. I (we) agree to abide by the rules and regulations of The American Kennel Club in effect at the time of this show, obedience trial and/or agility trial, and by any additional rules and regulations appearing in the premium list for this show, obedience trial and/or agility trial, and further agree to be bound by the "Agreement" printed on the reverse side of this entry form. I (we) certify and represent that the dog entered is not a hazard to persons or other dogs. This entry is submitted for acceptance on the foregoing representation and agreement.

SIGNATURE of owner or his agent duly authorized to make this entry \_\_\_\_\_

TELEPHONE NUMBER (Include Area Code) \_\_\_\_\_

E-MAIL ADDRESS \_\_\_\_\_



## AGREEMENT

I (we) acknowledge that the "Rules Applying to Dog Shows/Registration and Discipline" and, if this entry is for an obedience trial and/or agility trial, the "Obedience Regulations", and/or the "Agility Trial Regulations", have been made available to me (us), and that I am (we are) familiar with their contents. I (we) waive any and all claims, causes of action, I (we) might otherwise have against the AKC and any AKC approved judge, judging at this show, under the "AKC Rules, Regulations and Guidelines". I (we) agree that the club holding this show, obedience trial and/or agility trial has the right to refuse this entry for cause which the club shall deem to be sufficient. In consideration of the acceptance of this entry and of the holding of the show, obedience trial or agility trial and of the opportunity to have the dog judged and to win prize money, ribbons, or trophies, I (we) agree to hold this club, its members, directors, governors, officers, agents, superintendents or show secretary and the owner or lessor of the premises and any employees of the aforementioned parties, harmless from any claim for loss or injury which may be alleged to have been caused directly or indirectly to any person or thing by the act of this dog while in or upon the show or obedience trial premises or agility trial premises or grounds or near any entrance thereto, and I (we) personally assume all responsibility and liability for any such claim; and I (we) further agree to hold the aforementioned parties harmless from any claim for loss of this dog by disappearance, theft, death or otherwise, and from any claim for damage or injury to the dog, whether such loss, disappearance, theft, damage or injury, be caused or alleged to be caused by the negligence of the club or any of the parties aforementioned, or by the negligence of any other person, or any other cause or causes. I (we) hereby assume the sole responsibility for and agree to indemnify and save the aforementioned parties harmless from any and all loss and expense (including legal fees) by reason of the liability imposed by law upon any of the aforementioned parties for damage because of bodily injuries, including death at any time resulting therefrom, sustained by any person or persons, including myself (ourselves) or on account of damage to property, arising out of or in consequence of my (our) participation in this show or obedience trial or agility trial, howsoever such injuries, death or damage to property may be caused, and whether or not the same may have been caused or may have been alleged to have been caused by negligence of the aforementioned parties or any of their employees or agents, or any other persons.

## INSTRUCTIONS

- (Variety) if you are entering a dog of a breed in which there are varieties for show purposes, please designate the particular variety you are entering i.e., Cocker Spaniel (solid color black, ASCOB, parti-color). Beagles (not exceeding 13 in., over 13 in. but not exceeding 15 in.). Dachshunds (longhaired, smooth, wirehaired), Bull Terriers (colored, white), Manchester Terriers (standard, toy), Chihuahuas (smooth coat, long coat), English Toy Spaniels (King Charles and Ruby, Blenheim and Prince Charles), Poodles (toy, miniature, standard), Collies (rough, smooth).
- The following categories or dogs may be entered and shown in Best of Breed competition; Dogs that are Champions of Record and dogs which according to their owners records, have completed the requirements for a championship, but whose championships are unconfirmed. The showing of unconfirmed Champions in Best of Breed competition is limited to a period of 90 days from the date of the show where the dog completed the requirements for a championship.
- (Dog Show Class) Consult the classification in the show's premium list. If the dog show class in which you are entering your dog is divided, then, in addition to designating the class, specify the particular division of the class in which you are entering your dog, i.e. age division, color division, weight division.
- A dog must be entered in the name of the person who actually owned it at the time entries for a show closed. If a registered dog has been acquired by a new owner, it must be entered in the name of its new owner in any show for which entries closed after the date of acquirement, regardless of whether the new owner has received the registration certificate indicating that the dog is recorded in his name. State on entry form whether transfer application has been mailed to A.K.C. (For complete rule refer to Chapter 11, Section 3).

**If this entry is for Junior Showmanship, please give the following:**

**AKC Junior Handler # \_\_\_\_\_ Junior's Date of Birth \_\_\_\_\_**

The above number **MUST** be included. Should you not have your Junior Handler number, this may be obtained from the American Kennel Club. (Phone) 919-854-0136.

ADDRESS \_\_\_\_\_

CITY \_\_\_\_\_ STATE \_\_\_\_\_ ZIP \_\_\_\_\_

If Junior Handler is not the owner of the dog identified on the face of this form, what is the relationship of the Junior to the owner?