

#2017158512, #2017158513, #2017158514, #2017158515

## IRISH SETTER CLUB OF GREATER TULSA, INC.

All-Breed Scent Work Trials

Classes limited to 8 hours of judging

OPEN TO ALL AKC RECOGNIZED BREEDS



THIS SHOW WILL BE INDOORS AND UNBENCHED

Air Conditioned, Fully Matted Rings

**Saturday, Dec. 2, 2017 - Sunday, Dec 3, 2017**

All Breed Scent Work

**Companion Dog School of Tulsa**

**4411 South 91<sup>st</sup> East Ave. - Tulsa, OK 74145**

SHOW HOURS: 8:00 a.m. to 6:00 p.m.

CLUB WEBSITE: [iscgt.org](http://iscgt.org)

**ENTRIES CLOSE AT 6:00 p.m. on Thursday Nov 30, 2017**

MAIL ALL ENTRIES WITH CHECKS PAYABLE TO:

ISCGT

5741 E Meadowmere, Springfield, MO 65809 – (417) 234-6141

EMAIL: [wicklowsetters@gmail.com](mailto:wicklowsetters@gmail.com)

Permission has been granted by the American Kennel Club for the holding of this event under American Kennel Club rules and regulations.

Gina M. Dinardo, Secretary



## OFFICERS

President	Susan Moren
Vice President	Jeanine Harris
Treasurer	Hugh Holly III
Secretary	Anna Vaughn

8316 East 14<sup>th</sup> St. - Tulsa, OK 74112 (918) 906-3776 - [anna@cme-usa.com](mailto:anna@cme-usa.com)

## BOARD OF DIRECTORS

Sarah Schroeder	Jana Davis	Holly Kruse
-----------------	------------	-------------

## SHOW COMMITTEE

Scent Work Chairman	Anna Vaughn
Scent Work Secretary	Sarah Schoeder
Chief Ring Steward	Jana Davis
Trophies	Jeanine Harris
Grounds	Hugh Holly III

Trial Photographer	Sonja Jo Hahn
--------------------	---------------

PO Box 602 - Bixby, OK 74008 [shutterbugrebel@aol.com](mailto:shutterbugrebel@aol.com)

## JUDGES

**Saturday, December 2, 2017** **Sunday, December 3, 2017**

**Dovie Ryan**

7224 S Dennis Blvd, Broken Arrow, OK 74014

## ENTRY FEES

(All Fees include AKC Recording Fee)

Entry Fee	\$20.00
-----------	---------

**ENTRY DEADLINE:** Thursday November 30, 2017 – 6:00 p.m.

**SHOW SECRETARY:** Sarah Schroeder 5741 E Meadowmere, Springfield, MO 65809

[wicklowsetters@gmail.com](mailto:wicklowsetters@gmail.com)

## SHOW VETERINARIAN

### **Animal Emergency Center, Inc.**

4055 S. 102<sup>nd</sup> East Ave. – Tulsa, OK 74146

(918) 665-0508

Open 24/7

Located less than 1.5 miles from the show site.

### **Directions:**

Turn right (North) out of the show site parking.

Turn right onto E BA Frontage Rd.

Turn left onto S. Mingo Rd.

Take the 2<sup>nd</sup> right onto E 41<sup>st</sup> St.

Take the 2<sup>nd</sup> left onto S 102<sup>nd</sup> St.

Located directly behind Popeye's Chicken

## Scent Work

Handler Discrimination A & B Novice

Handler Discrimination A & B Advanced

[Move ups will be allowed between each trial](#)

## *HANDLER DISCRIMINATION DIVISION*

**Handler Discrimination** classes are titling classes in which the targeted scent is that of the handler themselves. Handlers are required to provide their own scented articles in a plastic bag, for the Novice class, one cotton glove or cotton sock. Three qualifying scores are required to earn titles in each class. Handlers may utilize any method they feel is best to **scent their article**.

## *DOG ELIGIBLE TO ENTER*

This trial is open to all dogs SIX (6) months of age or older that are registered with the American Kennel Club or that have AKC Limited Registration, Purebred Alternative Listing/Indefinite Listing Privileges (PAL/ILP), an AKC Canine Partners listing number or approved Foundation Stock Service (FSS) breeds are eligible to participate.

Dogs with a Purebred Alternative Listing/Indefinite Listing Privileges (PAL/ILP) or an AKC Canine Partners listing number must be spayed or neutered in order to compete. Wherever the word "dog" is used in these regulations it includes both sexes.

Dogs with physical challenges (including amputees) are eligible to participate provided that, in the opinion of the judge, the dog displays no sign of physical discomfort and can safely complete the search. Deaf and blind dogs are allowed to enter. Females in season may not participate, aggressive dogs, or dogs suffering from an injury, or illness which may affect the dog's physical or mental performance may not participate. No dog shall compete if it is sutured, bandaged, or has any visible wounds.

## *STAGING AREA, HANDLER'S BRIEFING, AND WARM-UP INFORMATION*

**Staging Area** will be out of view of search area(s). Staging area will include crating, warmup and waiting area, as well as the secretary table for check-ins and posting of running order and results.

The **Handler's Briefing** will take place in view of the search area prior to the start of each class, after the hide(s) have been set and after the Demo Dog has run. In the Handler's Briefing the judge will explain if there's an off-leash option, number of hides, maximum height of hides and maximum time for the search. **NO DOGS** are to be present during the Handler's Briefing.

**Spectator Area.** Spectators are encouraged. Any person not handling a dog in the current class, or any person who has already completed their run in the class may choose to watch the search from the spectator area. Handlers may not watch other exhibitors from their class prior to their run except in the case of Handler Discrimination classes. No one outside the search area may assist the handler or disclose the location of the hide. Spectators who intentionally or unintentionally give aid to a team may be ask to leave the area by the judge. Spectators are forbidden to discuss details of the search with handlers who have not run.

**Exhibitors are responsible** for cleaning up after their dog(s). Any exhibitor failing to do so may be excused without benefit of refund if the Event Committee deems the exhibitor to be in violation of this requirement. Cleaning supplies and disposal sites will be available at various locations around the show grounds.

## Scent Work RIBBONS

First Prize  
Second Prize  
Third Prize  
Fourth Prize

Blue Ribbon  
Red Ribbon  
Yellow Ribbon  
White Ribbon

New Title Ribbons will be Available

## FREE LUNCH PROVIDED!!!

### ROUTE TO THE SHOW

#### From Interstate 44:

Exit #231 S. Memorial Ave.  
Drive South to 46<sup>th</sup> Street (light)  
Turn Left Drive to South 91<sup>st</sup> East Ave.  
Turn Left The show grounds are on the Right.  
THERE WILL BE SIGNS POSTED

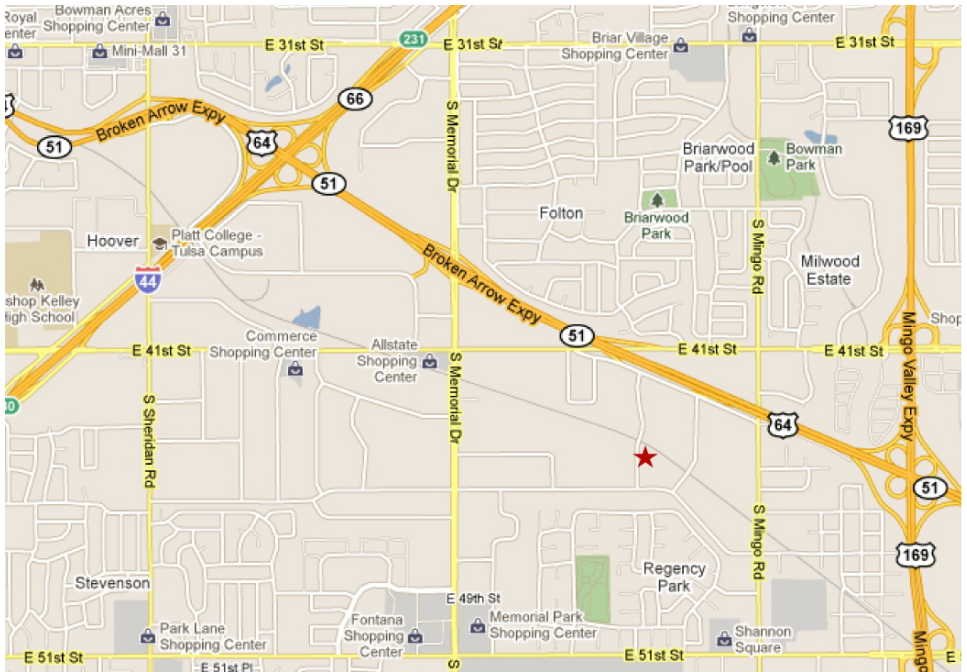

## ACCOMODATIONS

LaQuinta Tulsa East 10829 East 41 <sup>st</sup> St. Tulsa, OK 74146	(918) 665-0220 (800) 753-3757 <b>Pet Friendly</b>
Expo Square RV Park 3900 East 15 <sup>th</sup> St. Tulsa, OK 74114	(918) 744-1113 exposquare.com

## CONVENIENCES

TGI Fridays	5359 East 41 <sup>st</sup> St. Tulsa, OK 74135
On the Border	5340 East 41 <sup>st</sup> St. Tulsa, OK 74135
Promenade Mall	4107 South Yale Ave. Tulsa, OK 74135

## NOTICE TO EXHIBITORS

Entry Fees include \$3.50 AKC Event Fee and \$.50 AKC recording fee.

Dogs will be shown indoors in air conditioned building - crating and grooming areas are available.

THERE WILL BE NO ALCOHOL ALLOWED ON THE PREMISIS.

Dogs need be present only for judging. ALL DOGS MUST BE OUT OF THE BUILDING 1 HOUR AFTER JUDGING ENDS. NO EXCEPTIONS!

Entry fees will not be refunded in the event a dog is absent, disqualified, excused by the judge or barred from competition by action of the Trial Committee.

If because of riots, civil disturbances or other acts beyond the control of the match-giving club it is impossible to open or complete the match, no refund of entry fees will be made.

Dogs must be ready for judging. The owner or handler of each dog is solely responsible for having such dog ready at ringside when his class is ready to be judged.

Space will not be provided at this trial for un-entered dogs.

The trial-giving club and its membership assume no responsibility for any loss, damage or injury sustained by exhibitors, handlers or any of their dogs or property, and further assume no responsibility for injury to children.

Officers and members of the Irish Setter of Greater Tulsa will exhibit dogs at this trial.

Exhibitors and handlers will be held responsible for clean conditions in and around their crating and grooming area.

Parents will be held responsible for the conduct of their children at this trial.

No entry shall be made, and no entry shall be accepted, which specifies any condition as to its acceptance. Entries will not be accepted without fees or signatures.

Changes, additions or corrections to entry forms must be received in writing or by telegram prior to close of entries. Those received by telephone are not acceptable.

# AKC Official Entry Form



**Send to:**  
**Sarah Schroeder**

5741 E Meadowmere, Springfield, MO 65809

	Handler Discrimination
Saturday 12-02-17	<input type="checkbox"/> Novice A <input type="checkbox"/> Novice B <input type="checkbox"/> Advanced A <input type="checkbox"/> Advanced B
Sunday 12-03-17	<input type="checkbox"/> Novice A <input type="checkbox"/> Novice B <input type="checkbox"/> Advanced A <input type="checkbox"/> Advanced B

**Entry fees: \$20 per class (\$20 for additional entries of same dog)**

*Make checks payable to the ISCGT*

**Trial Secretary will add a \$30.00 collection fee to the amount of each returned check.**

AKC Registered Name		Registration Number
		<input type="checkbox"/> AKC/PAL/ILP/CP <input type="checkbox"/> Foreign
Call name	Date of birth	Sex
Breed		Variety
Breeder		
Sire		
Dam		
Owner		
Owner's Address		
City	State	Zip
Telephone	Email	
Handler name (if different from owner):	Junior Handler # (if applicable):	

**Fields marked in blue are REQUIRED.**

**Fields marked in gray must be completed if the information is known.**

**\*\*\*Be sure to read the Agreement and sign on the reverse. No form will be processed without your signature!\*\*\***

---

**AKC Rules, Regulations, Policies and Guidelines are available on the American Kennel Club Web site, [www.akc.org](http://www.akc.org)**

I certify that I am the actual owner of the dog, or that I am the duly authorized agent of the actual owner whose name I have entered. In consideration of the acceptance of this entry, I (we) agree to abide by the rules and regulations of The American Kennel Club in effect at the time of this event, and any additional rules and regulations appearing in the premium list of this event and entry form and any decision made in accord with them. I (we) agree that the club holding this event has the right to refuse this entry for cause which the club shall deem sufficient. I (we) certify and represent that the dog entered is not a hazard to persons or other dogs. In consideration of the acceptance of this entry and of the holding of this event and of the opportunity to have the dog judged and to win prizes, ribbons, or trophies, I (we) agree to hold the AKC, the event-giving club, their members, directors, governors, officers, agents, superintendents or event secretary and the owner and/or lessor of the premises and any provider of services that are necessary to hold this event and any employees or volunteers of the aforementioned parties, and any AKC approved judge, judging at this event, harmless from any claim for loss or injury which may be alleged to have been caused directly or indirectly to any person or thing by the act of this dog while in or about the event premises or grounds or near any entrance thereto, and I (we) personally assume all responsibility and liability for any such claim; and I (we) further agree to hold the aforementioned parties harmless from any claim of loss, injury or damage to this dog.

Additionally, I (we) hereby assume the sole responsibility for and agree to indemnify, defend and save the aforementioned parties harmless from any and all loss and expense (including legal fees) by reason of the liability imposed by law upon any of the aforementioned parties for damage because of bodily injuries, including death at any time resulting therefrom, sustained by any person or persons, including myself (ourselves), or on account of damage to property, arising out of or in consequence of my (our) participation in this event, however such, injuries death or property damage may be caused, and whether or not the same may have been caused or may be alleged to have been caused by the negligence of the aforementioned parties or any of their employees, agents, or any other person. I (we) agree that the determination of whether the injury is serious shall be made by the event veterinarian and is binding on me (us). I (WE) AGREE THAT ANY CAUSE OF ACTION, CONTROVERSY OR CLAIM ARISING OUT OF OR RELATED TO THE ENTRY, EXHIBITION OR ATTENDANCE AT THE EVENT BETWEEN THE AKC AND THE EVENT-GIVING CLUB (UNLESS OTHERWISE STATED IN THIS PREMIUM LIST) AND MYSELF (OURSELVES) OR AS TO THE CONSTRUCTION, INTERPRETATION AND EFFECT OF THIS AGREEMENT SHALL BE SETTLED BY ARBITRATION PURSUANT TO THE APPLICABLE RULES OF THE AMERICAN ARBITRATION ASSOCIATION. HOWEVER, PRIOR TO ARBITRATION ALL APPLICABLE AKC BYLAWS, RULES, REGULATIONS, AND PROCEDURES MUST FIRST BE FOLLOWED AS SET FORTH IN THE AKC CHARTER AND BYLAWS, RULES, REGULATIONS, PUBLISHED POLICIES AND GUIDELINES.

## INSTRUCTIONS

Dogs must have prior title to compete in upper level classes when those are offered.

**SIGNATURE** of owner or his agent duly authorized to make this entry.

**SIGN HERE**

**X:** \_\_\_\_\_

**Phone #:** \_\_\_\_\_

**Email:** \_\_\_\_\_

**In case of Emergency – Name:** \_\_\_\_\_